



# Swan-Fix i-Size USER MANUAL

- 40cm-125cm
- Birth-7 years
- ≤21 kg
- UNECE regulation no. R129



GB

51161571 24/07

## 1 PRODUCT OVERVIEW

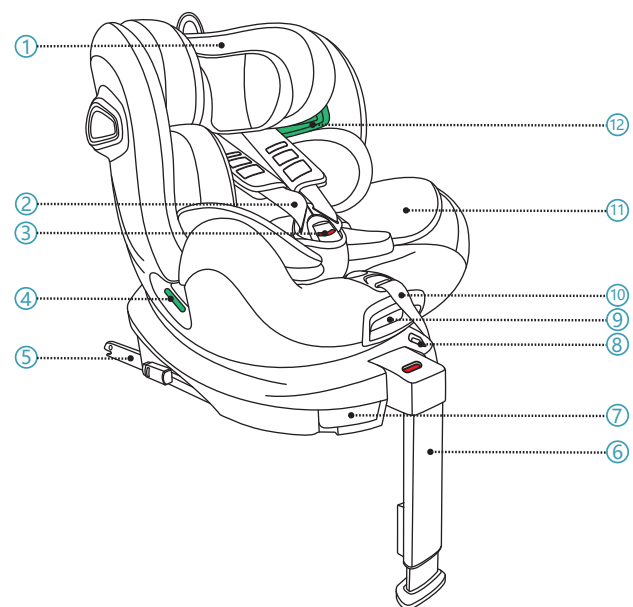

- |                           |                              |
|---------------------------|------------------------------|
| 1. Headrest               | 7. Rotation Release Handle   |
| 2. 5-Point Harness        | 8. Age Limiter               |
| 3. 5-Point Harness Buckle | 9. Recline Adjustment Handle |
| 4. Lap Belt Guide         | 10. 5-Point Harness Adjuster |
| 5. ISOFIX Connector       | 11. Newborn Insert           |
| 6. Support Leg            | 12. Shoulder Belt Guide      |

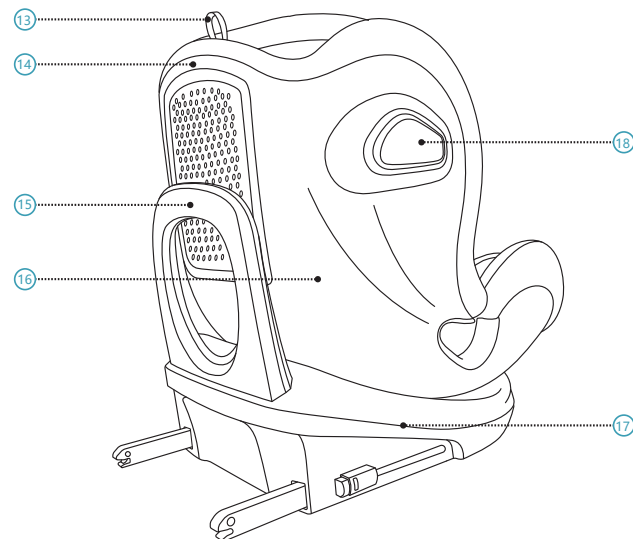

- |                              |                                       |
|------------------------------|---------------------------------------|
| 13. Headrest Adjustment Ring | 16. Shell                             |
| 14. Backrest                 | 17. Base                              |
| 15. Rebound Bar              | 18. Integrated Side Impact Protection |

## 2 INSTRUCTION

Thank you for choosing AVOVA Swan-Fix i-Size to ensure your child's safe journey. The seat has been designed, tested and certified according to UNECE R.129, the Enhanced Child Restraint Systems. The seal of approval can be found at the back of the seat base. Swan-Fix i-Size is approved as a child seat for a child with statures of 40-125 cm, approximately from birth to 7 years old. It is a Universal child seat that fits most but not all vehicles. Please refer to your vehicle's handbook.

It is important that you read this user manual BEFORE installing your child seat. Incorrect installation and/or misuse of the seat could endanger your child. Please keep your preferred language version of this user manual in the user manual pocket behind the headrest cover, so users can refer to it any time.

Range	Installation	Facing	Securing
40-105 cm	ISOFIX and Support Leg	Rearward	5-point Harness, max 21 kg child weight
76-105 cm and ≥15 months	ISOFIX and Support Leg	Forward	5-point Harness, max 21 kg child weight
100-125 cm	ISOFIX+Adult 3-point Belt	Forward	3-point Belt

The following symbols are used in this user manual:

- ⚠ DANGER** DANGER indicates a hazardous situation which, if not avoided, will result in death or serious injury.
- ⚠ WARNING** WARNING indicates a hazardous situation which, if not avoided, could result in death or serious injury.
- ⚠ CAUTION** CAUTION indicates a hazardous situation which, if not avoided, could result in minor or moderate injury.

### GENERAL SAFETY INFORMATION

**⚠ DANGER** AVOVA Swan-Fix i-Size is compatible with universal seating positions in vehicles. For suitable positions in your vehicle, please read your vehicle's handbook.

**⚠ DANGER** The child seat can only be used in vehicle seats with ISOFIX Anchoring Points. Please refer to your vehicle's handbook.

**⚠ DANGER** The child seat must not be used rearward-facing on a vehicle seat with active airbag. An active airbag will cause serious injury to a child in rearward-facing child seat. The child seat must be installed on a vehicle seat without active airbag or with airbag deactivated.

**⚠ DANGER** Always use the Newborn Insert till your child is above 75 cm in stature.

**⚠ DANGER** Always use the 5-point Harness when your child is less than 100 cm in stature, to a maximum of 105 cm in stature or 21 kg in weight. When your child is above the limit, always use the vehicle's 3-point Safety Belt.

**⚠ DANGER** If the child is to be secured by the vehicle's 3-point Belt, the child seat must be installed on vehicle seats approved to UNECE Regulation No.16 or equivalent standards. Please check your vehicle's handbook.

**⚠ DANGER** When the child is taller than 125 cm or the child's shoulders exceed the highest position of the Shoulder Belt Guides, the child must change to a seat which is suitable for taller children.

**⚠ DANGER** The Support Leg is encased in the Seat Base for transportation, and it should unfold automatically when the child seat is taken out from its carton. Make sure to engage the Support Leg firmly on the vehicle floor when your child is secured by 5-point Harness. Make sure to disengage the Support Leg and encase it back in the Seat Base when your child is secured by 3-point Belt.

**⚠ DANGER** All passengers shall be informed on how to release your child in the case of an emergency.

**⚠ WARNING** Use on the rear seat: Move the front seat forward far enough that the child's feet cannot reach the backrest of the front seat as that is safer.

**⚠ WARNING** Please dispose of your child seat in the event of any vehicle and/or violent collision as the seat may be damaged but the damage may not be immediately visible.

**⚠ WARNING** Swan-Fix i-Size features crumple structures to absorb collision energy in its ISIP system. After a side collision, the structures may have crumpled without showing outside. Please dispose of your child seat after any vehicle and/or violent collision.

**⚠ WARNING** Do not use lubricants on, modify or make any addition to your child seat, which could seriously affect its ability to protect your child.

**⚠ WARNING** Do not use any aggressive cleaning products, which may harm the material of the child seat.

**⚠ WARNING** The child seat needs to be checked regularly to ensure all the parts are functioning correctly and free from any damages.

**⚠ WARNING** The child seat must be secured by ISOFIX Connectors when it is in the vehicle, even if no child is being transported.

**⚠ WARNING** Never leave your child unattended in the child seat.

**⚠ WARNING** Make sure luggage and other objects are properly secured. Unsecured luggage may cause severe injuries to children and adults in case of accidents.

**⚠ WARNING** AVOVA advises that child seats should not be bought or sold second-hand.

**⚠ WARNING** Remove the 5-point Harness after your child is big enough to be secured by 3-point Belt.

**⚠ CAUTION** Do not expose the child seat under intensive direct sunlight. A child seat too hot could harm the child.

**⚠ CAUTION** The rigid items and plastic parts of the child seat shall be so located and installed that they are not liable, during everyday use of the vehicle, to become trapped by a movable seat or in a door of the vehicle.

**⚠ CAUTION** The vehicle seats may show signs of wear and tear when using child seat. In order to avoid that, car seat protectors may be used.

**⚠ CAUTION** DO NOT use at home. It's not designed for home use and can only be used in a vehicle.

**⚠ CAUTION** Please mind your fingers when operating the child seat.

If in doubt, consult either the child seat manufacturer or the retailer.

## 3 INSTALLATION

Swan-Fix i-Size must be installed on vehicle seats by engaging the ISOFIX Connectors to the ISOFIX Anchoring Points of the vehicle. When installed with ISOFIX and Support Leg, it is for a child from 40 to 105 cm in stature and the child must be secured by 5-point Harness. When installed with ISOFIX and WITHOUT Support Leg, it is for a child from 100 to 125 cm in stature and the child must be secured by the vehicle's 3-point Belt. It is compatible with Universal seating positions in vehicles. For suitable positions in a vehicle, please refer to your vehicle handbook.

Range	Installation
40-75 cm	ISOFIX and Support Leg
76-105 cm and ≥15 months	ISOFIX and Support Leg
100-125 cm	ISOFIX+Adult 3-point Belt

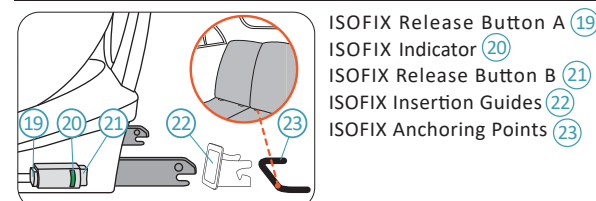

### GETTING READY

**⚠ WARNING** Please ensure the vehicle seat that has the child seat installed is in upright position if the vehicle seat is reclinable.

**Optional.** Fit the ISOFIX Insertion Guides (22) to the vehicle's ISOFIX Anchoring Points (23).

**⚠ CAUTION** Using ISOFIX Insertion Guides to help in the installation of the child seat is optional, but it is recommended. They help to mitigate damages to the vehicle seat. When you want to fold the vehicle seat, remove the ISOFIX Insertion Guides before doing so.

**⚠ CAUTION** For some vehicle models, the vehicle seat may come with built-in ISOFIX guides, so the ISOFIX Insertion Guides could not be used.

**⚠ CAUTION** Fold the Support Leg before installation if your child is to be secured by 3-point Belt.

### START INSTALLATION

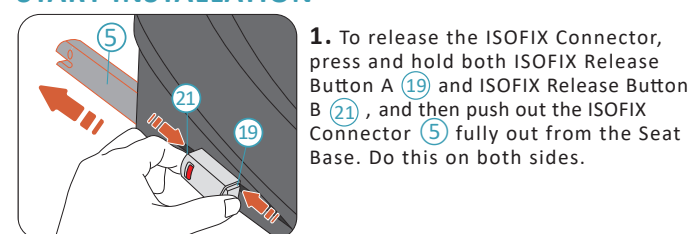

1. To release the ISOFIX Connector, press and hold both ISOFIX Release Button A (19) and ISOFIX Release Button B (21), and then push out the ISOFIX Connector (5) fully out from the Seat Base. Do this on both sides.

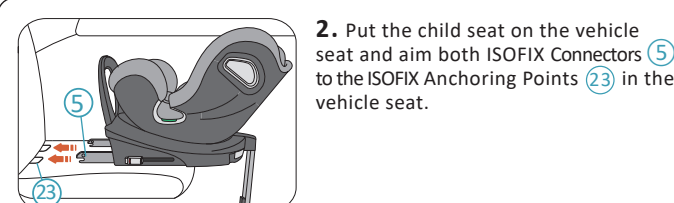

2. Put the child seat on the vehicle seat and aim both ISOFIX Connectors (5) to the ISOFIX Anchoring Points (23) in the vehicle seat.

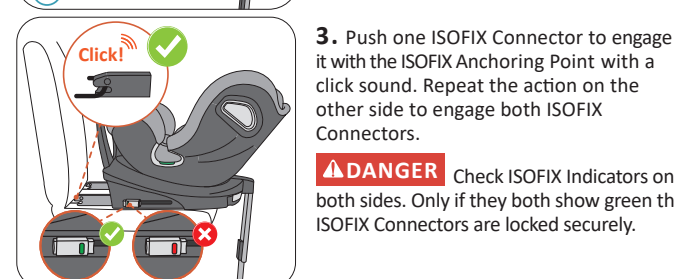

3. Push one ISOFIX Connector to engage it with the ISOFIX Anchoring Point with a click sound. Repeat the action on the other side to engage both ISOFIX Connectors.

**⚠ DANGER** Check ISOFIX Indicators on both sides. Only if they both show green the ISOFIX Connectors are locked securely.

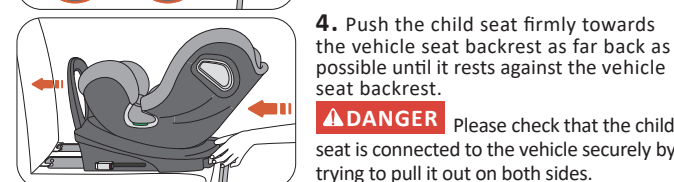

4. Push the child seat firmly towards the vehicle seat backrest as far back as possible until it rests against the vehicle seat backrest.

**⚠ DANGER** Please check that the child seat is connected to the vehicle securely by trying to pull it out on both sides.

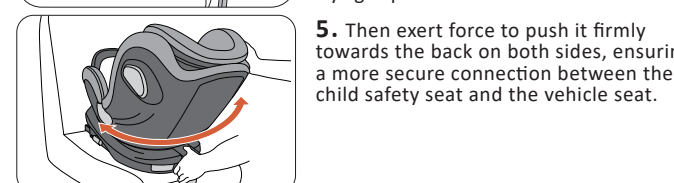

5. Then exert force to push it firmly towards the back on both sides, ensuring a more secure connection between the child safety seat and the vehicle seat.

**A. INSTALL WITH SUPPORT LEG IN ADDITION TO ISOFIX**  
When installed with ISOFIX and Support Leg, the child seat is for a child from 40 to 105 cm in stature and the child must be secured by 5-point Harness. Use rearward-facing only when your child is less than 15 months old. Use either rearward-facing or forward-facing when your child is over 15 months and at least 76 cm in stature.

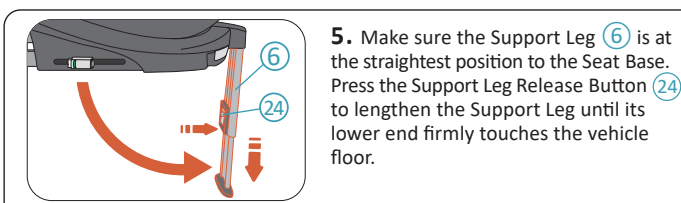

5. Make sure the Support Leg (6) is at the straightest position to the Seat Base. Press the Support Leg Release Button (24) to lengthen the Support Leg until its lower end firmly touches the vehicle floor.

**⚠ DANGER** Check the Support Leg Indicator (25) at the top of the Support Leg. Only when it shows green sign the Support Leg is installed firmly.

**⚠ DANGER** The Support Leg shall be firmly installed on the vehicle floor, not free from the vehicle floor or touching other objects. The length of Support Leg shall not raise the child seat upwards from touching the vehicle seat.

**B. INSTALL WITH 3-POINT BELT IN ADDITION TO ISOFIX**  
When installed with ISOFIX and Safety Belt, the child seat is for a child from 100 to 125 cm in stature and the child must be secured by the vehicle's 3-point Safety Belt. Use forward-facing only.

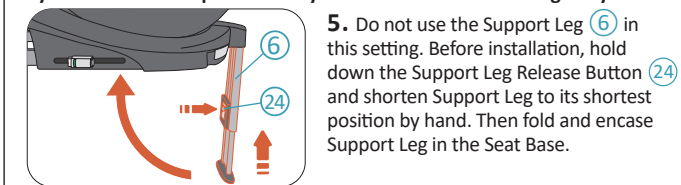

5. Do not use the Support Leg (6) in this setting. Before installation, hold down the Support Leg Release Button (24) and shorten Support Leg to its shortest position by hand. Then fold and encase Support Leg in the Seat Base.

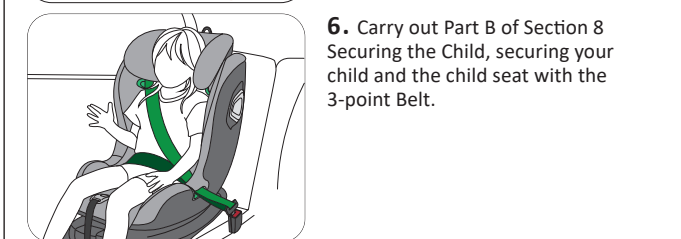

6. Carry out Part B of Section 8 Securing the Child, securing your child and the child seat with the 3-point Belt.

**⚠ WARNING** Make sure the child seat Backrest rests against the vehicle seat backrest firmly, and that the vehicle seat headrest is not pushing the child seat away. You may adjust the vehicle seat headrest to the highest position or even remove the vehicle seat headrest if needed.

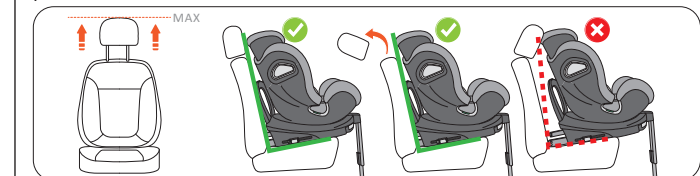

## 4 CHILD SEAT ROTATION

Swan-Fix i-Size has a Seat Shell that can rotate 360 degrees on the child seat Base. When your child is no more than 76 cm in stature or less than 15 months old, always secure your child in the rearward-facing direction. When your child is between 76 and 105 cm in stature, secure your child in either the rearward-facing direction or forward-facing direction. After your child is over 105 cm in stature, only use the forward-facing direction.

Range	Facing
40-105 cm	Rearward
76-105 cm and ≥15 months	Forward
100-125 cm	Forward

**⚠ DANGER** The child seat can be rotated to facing the sides (like towards the vehicle door) for easy access only, but never transport your child in this way.

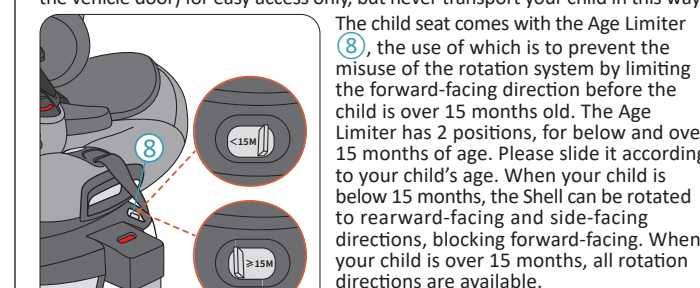

The child seat comes with the Age Limiter (8), the use of which is to prevent the misuse of the rotation system by limiting the forward-facing direction before the child is over 15 months old. The Age Limiter has 2 positions, for below and over 15 months of age. Please slide it according to your child's age. When your child is below 15 months, the Shell can be rotated to rearward-facing and side-facing directions, blocking forward-facing. When your child is over 15 months, all rotation directions are available.

**⚠ DANGER** Do not use forward-facing before your child is 15 months old.

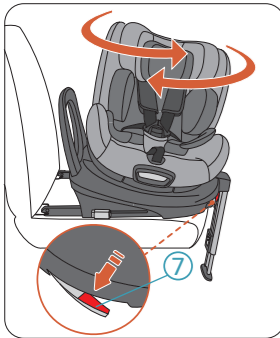

Pull the Rotation Release Handle (7) to release the child seat Shell from its locked position. Now you can rotate the Shell. The Shell has 2 locked positions, forward-facing and rearward-facing. When the Shell is moved to a locked position, it will automatically lock with a click sound and the Rotation Release Button will go back into the Base. The Shell also has two side intermediate stopping positions (unlocked) so that the child can be put in or take out from the seat easily.

**⚠ DANGER** When the Shell is properly locked, Rotation Release Handle will go back into the base and the red colour indication shall be hidden. If red is seen on the handle, do not start your travel.

**⚠ DANGER** Try to rotate the child seat shell without releasing it before each travel to make sure it's locked.

**⚠ DANGER** Do not travel when the child seat is not locked in either the forward-facing or rearward-facing direction. Side-facing is not allowed for travel.

## 5 ADJUSTING THE RECLINE

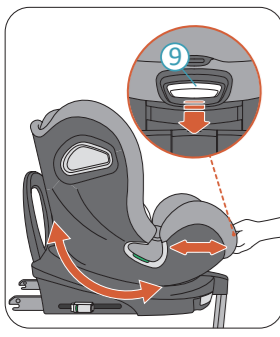

Swan-Fix i-Size has 3 recline positions in forward-facing direction and 3 recline positions in rearward-facing direction. To adjust the recline position, pull the Recline Adjustment Handle (9), and slide the child seat Shell by pushing and pulling it back and forth against the Base.

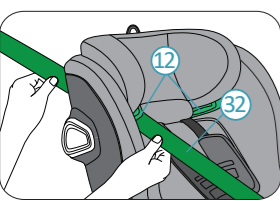

4. Route the Shoulder Belt Section (32) into the green Shoulder Belt Guide (12) under the Headrest, until it lies completely in the Shoulder Belt Guide. Check that the Shoulder Belt Section is not twisted.



**⚠ DANGER** Check that the Shoulder Belt Section (32) runs over your child's collar-bone, not across the neck.

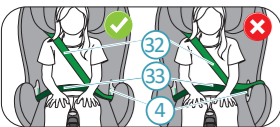

**⚠ DANGER** Check that both of the Shoulder Belt Section (32) and the Lap Belt Section (33) run firmly in the Lap Belt Guide (4).

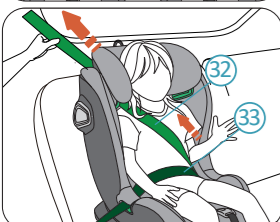

5. Remove the slack of the 3-point belt so it firmly secures the child. First pull the Shoulder Belt Section (32) that crosses the body of the child to remove the slack from the Lap Belt Section (33). Then pull the Shoulder Belt Section above the child seat to remove the remaining slack.

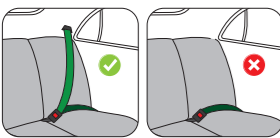

**⚠ DANGER** Never secure your child or the child seat with a 2-point belt as that may cause serious injuries or death in the event of an accident.

## 6 NEWBORN INSERT

Range	Newborn Insert
40-75 cm	Yes
76-105 cm and ≥15 months	No
100-125 cm	No

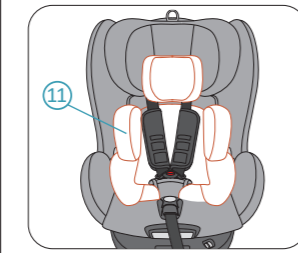

Always use the Newborn Insert (11) when the child is no more than 75 cm in stature.

## 7 HEADREST ADJUSTMENT

**⚠ WARNING** The Headrest (1) of the child seat shall be adjusted to a level that the Shoulder Belt Guides (12) are just above the child's shoulders.

**⚠ WARNING** As the child grows, the child seat Headrest (1) shall be adjusted from time to time.

**⚠ CAUTION** When the 5-point Harness is fastened, it may block the Headrest from being adjusted to higher positions. In this case, loosen the 5-point Harness first.

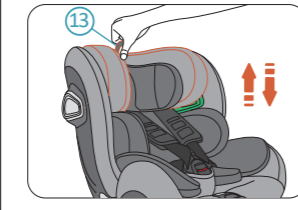

Pull and hold the Headrest Adjustment Ring (13) on the back of the Headrest to release the Headrest. Move the Headrest to the correct height, placing the Shoulder Belt Guides just above the child's shoulders. Then release the ring to lock the height of the Headrest.

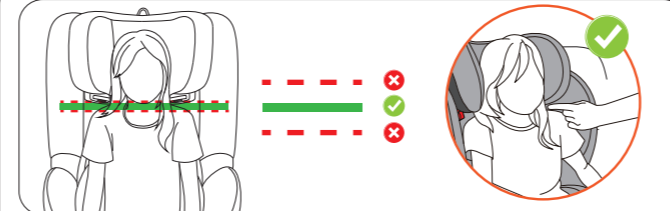

## 8 SECURING THE CHILD

Range	Securing
40-105 cm	5-point Harness, max 21 kg child weight
76-105 cm and ≥15 months	5-point Harness, max 21 kg child weight
100-125 cm	3-point Belt

### A. SECURE YOUR CHILD WITH 5-POINT HARNESS

Your child with a stature between 40 and 105 cm can be secured by the 5-point Harness. Do not use the 5-point Harness if your child is over 21 kg in weight. Use the vehicle's 3-point Belt instead.

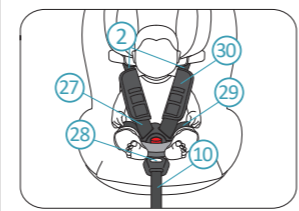

5-point Harness (2)  
Shoulder Harness (27)  
Harness Adjustment Button (28)  
Lap Harness (29)  
Chest Pads (30)  
5-point Harness Adjuster (10)

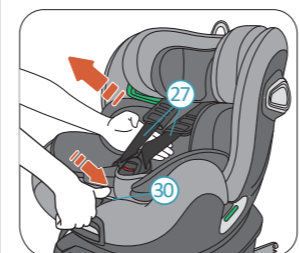

1. Hold down the Harness Adjustment Button (28) and pull Shoulder Harness (27) towards you as much as possible. Make sure you pull the shoulder harness from beneath the Chest Pads (30) as shown.

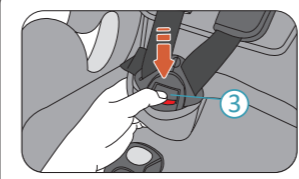

2. Press the red button on the 5-Point Harness Buckle (3) to unbuckle it.

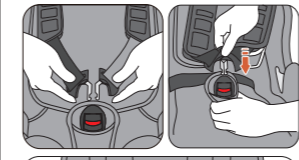

3. Seat your child in the child seat. Route the shoulder harness over your child's shoulders and engage the buckle tongues together. Click the engaged tongues into the buckle body.



4. Pull both Shoulder Harness (27) to tighten the Lap Harness (29).

**⚠ DANGER** Please check that the Lap harness is worn low down so that the child's pelvis is firmly engaged.

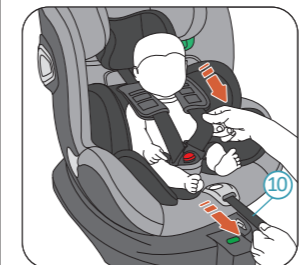

5. Pull the 5-Point Harness Adjuster (10) until the harness firmly secures your child. Finally pull both Chest Pads down fully.

**⚠ DANGER** Please check after tightening that none of the harness straps are twisted.

**⚠ CAUTION** When you want to release your child, follow steps 1 and 2.

### B. SECURE YOUR CHILD WITH 3-POINT BELT

Your child with a stature between 100 and 125 cm can be secured by the vehicle's 3-point Safety Belt.

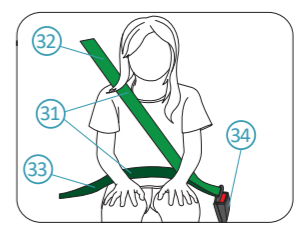

3-point Belt (31)  
Shoulder Belt Section (32)  
Lap Belt Section (33)  
3-point Belt Buckle (34)

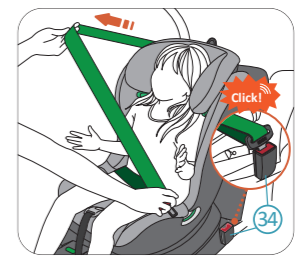

1. Seat your child in the child seat. Position the vehicle 3-point belt in front of the child and lock the belt into the 3-Point Belt Buckle (34) with a click.

**⚠ DANGER** Make sure the 3-Point Belt is not twisted. It should be adjusted to tightly hold the child's body.

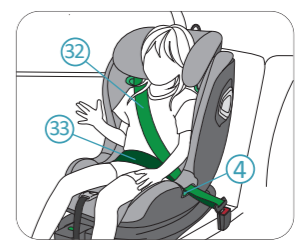

2. Place the Shoulder Belt Section (32) and the Lap Belt Section (33) on the side of the buckle into the Lap Belt Guide (4) of the Base.

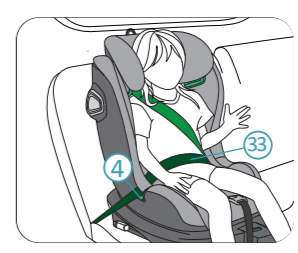

3. Place the Lap Belt Section (33) on the other side of the Base into the Lap Belt Guide (4).

**⚠ DANGER** The Lap Belt Section must lie as low as possible over the child's pelvis on both sides to provide the best protection.

**⚠ CAUTION** When you want to release the child, unbuckle the 3-point Belt and route the belt out from the Lap Belt Guides.

AFTER SECURING YOUR CHILD, PLEASE CHECK BELOW BEFORE YOUR TRAVEL:

- The Lap Belt Section is firmly in the Lap Belt Guides on both sides of the Base.
- The Shoulder Belt Section runs firmly in the Lap Belt Guide on one side and in the Shoulder Belt Guide on the other side.
- The whole 3-point Belt is tight and not twisted. The Safety Belt Buckle must not be caught in the Lap Belt Guide.

## 9 REMOVE THE 5-POINT HARNESS

Range	Securing
100-125 cm	3-point Belt

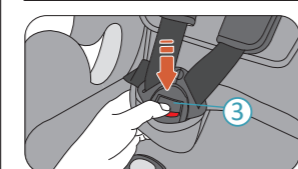

1. Rotate the child seat to forward-facing direction. Press the red button on the Harness Buckle (3) and open the harness.



2. Open the Chest Pads (30) by the sides. Detach the Chest Pads from the straps. Hide the straps behind Headrest cover. Please keep the detached Chest Pads.

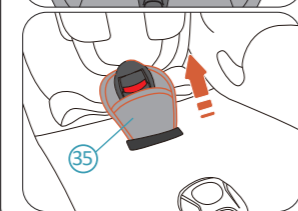

3. Pull out and remove the Crotch Pad (35) from the Crotch Strap. Please keep the removed Crotch Pad.

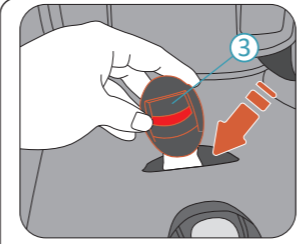

4. Hide the Crotch Strap and the Harness Buckle's (3) body in the child seat Shell, beneath the cover. There's reserved space for them at the seating area of the Shell.

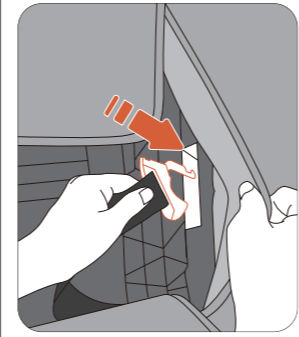

5. Hide the Shoulder Harness and Lap Harness in the side wings of the Shell, behind the cover of the child seat. There's reserved space for them in the side wings of the Shell.

**⚠ CAUTION** After removing the 5-point Harness, restore the seat cover and check seating for your child is comfortable. To refit the 5-point Harness, follow the steps in the reverse order and direction.

## 10 REMOVAL

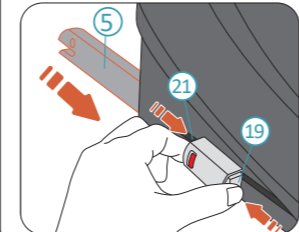

While pressing and holding both ISOFIX Release Button A (19) and ISOFIX Release Button B (21), slide the ISOFIX Connector (5) into the child seat Base. This shall be done on both sides of the child seat.

## 11 CARE AND MAINTENANCE



You may want to remove and wash the child seat's cover from time to time. Please do so with mild detergent in the delicates programme of the washing machine (≤30°). Please refer to the washing label of the cover. The plastic parts can be cleaned with a mild soap and water.

**⚠ DANGER** The child seat must not be used without the AVOVA seat cover. The cover is a safety feature and may only be replaced by an original AVOVA cover.

### REMOVING AND REFITTING THE SEAT COVER



1. Adjust the child seat to forward-facing. Remove the Newborn Insert (11).

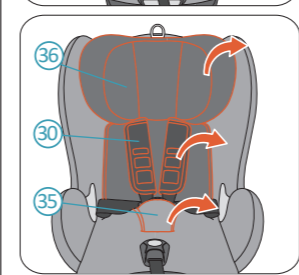

2. Remove the headrest cover (36). Unbuckle the 5-Point Harness. Remove the Chest Pads (30) and the Crotch Pad (35).

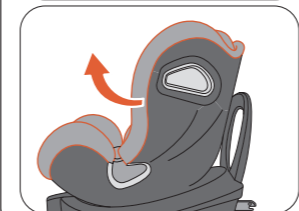

3. Release the cover hooks on both sides. Then remove the child seat shell cover.

## 12 WARRANTY

1. The warranty for AVOVA Swan-Fix i-Size lasts for 2 years from the date of original purchase from new. The usage of the product should be in accordance with this user manual. Any damage caused by operations against the instructions in this user manual will void the warranty.

2. Please keep your proof of purchase properly in case of a warranty claim.

3. Never use third parties for maintenance, repair or modification otherwise you will void the warranty. Always check with AVOVA retailers for advice.

If you have any further questions regarding the child seat's use, please feel free to contact us:  
AVOVA GmbH  
Blaubeurer Straße 71  
89077 Ulm  
Germany

T: +49 731 379941-0  
info@avova-childcare.com  
www.avova-childcare.com

## 13 DISPOSAL

When you need to dispose of the child seat, please refer to your local waste disposal regulations. If you have further questions, please contact your communal waste management or administration of your city.